

SITE DATA
PROPERTY OWNERS
COUNTY COMMISSIONERS OF
CHARLES COUNTY MARYLAND
200 BALTIMORE STREET
LA PLATA MD 20646
PROJECT PROPOSED BY:
CHARLES COUNTY GOVERNMENT
CO DEPARTMENT OF RECREATION, PARKS AND TOURISM
COUNTY GOVERNMENT BUILDING
8190 PORT TABACCO RD
PORT TABACCO MD, 20677
CONTACT: JAMES SANDY (301) 934-0106
ENGINEER
VISTA DESIGN, INC.
11634 WORCESTER HWY
SHOWELL, MD 21862
PH. 410-352-3874
FAX. 410-352-3875
CONTACT: STEVE ENGEL R.L.A.
WETLAND CONSULTANT
ENVIRONMENTAL RESOURCES, INC.
38173 DUPONT BLVD
SELBYVILLE, DE 19975
PH. 302-436-9637
FAX. 302-436-9639
CONTACT: ED LAUNAY

PROJECT FUNDED BY:
FUNDED IN COMBINATION OF CHARLES COUNTY GOVERNMENT, UNITED STATES FISH AND WILDLIFE COMMISSION,
AND STATE HIGHWAY TAP PROGRAM
TAX MAP & PARCELS
TAX MAP: 73 GRID: 7 PARCEL: 12
TAX MAP: 73 GRID: 20 PARCEL: 125 LIBER/FOLIO: 8625/57
TAX MAP: 73 GRID: 19 PARCEL: 40
FLOOD ZONE
PORTIONS OF THIS SITE ARE LOCATED WITHIN FLOOD ZONES "AE (EL. 6')", "AE (EL. 7') "X", AND
"VE (EL. 8') PER F.I.R.M. MAP #240170340D DATED MAY 4, 2015
NON-TIDAL WETLANDS
ON-SITE NON-TIDAL WETLANDS, TIDAL WETLANDS, AND WATERS OF THE UNITED STATES HAVE BEEN
DELINEATED BY ENVIRONMENTAL RESOURCES, INC.
RESOURCE CONSERVATION ZONE
A PORTION OF THIS PROJECT IS WITHIN THE RESOURCE CONSERVATION ZONE OVERLAY OF THE
CHESAPEAKE BAY CRITICAL AREA
TOPOGRAPHY
LIDAR PROVIDED BY CHARLES COUNTY AND PREPARED AND BLENDED WITH SURVEY BY VISTA
DESIGN, INC. WITHIN THE PROJECT "POPE'S CREEK TRAIL" AREA
HORIZONTAL & VERTICAL CONTROL
HORIZONTAL: NAD 83 MARYLAND STATE PLANE, US FEET
VERTICAL: NAVD 88

SHEET INDEX

SHEET	DESCRIPTION	DATE	REVISION
C-001	CONSTRUCTION SET COVER SHEET	C-206	MISC. SITE PLAN DETAILS
C-100	SITE PLAN KEY SHEET/PROPERTY MOSAIC	C-206	MISC. SITE PLAN DETAILS
C-101A	EXISTING CONDITIONS WATERFRONT	C-207	MISC. SITE PLAN DETAILS
C-101B	WATERFRONT SITE PLAN	C-208	SOIL BORING LOGS
C-101D	WATERFRONT SITE GRADING PLAN	C-209	SUBSURFACE INVESTIGATION AND GEOTECHNICAL EVALUATION
C-101E	TRAIL CROSSING PLAN (TRAFFIC GROUP)	C-301	SITE SWM PLAN
C-102	SITE PLAN STA. 0+00-8+00 PHASE-1A	C-302	SITE SWM DETAILS
C-103	SITE PLAN STA. 8+00-16+00 PHASE-1A	C-303	CULVERT REPLACEMENT ANALYSIS
C-104	SITE PLAN STA. 16+00-24+00 PHASE-1A	C-400	LANDSCAPE PLAN
C-105	SITE PLAN STA. 24+00-32+00 PHASE-1A	C-401	LANDSCAPE NOTES & DETAILS
C-106	SITE PLAN STA. 32+00-40+00 PHASE-1A	C-500	EROSION & SEDIMENT CONTROL PLAN KEY SHEET
C-107	SITE PLAN STA. 40+00-48+00 PHASE-1A	C-501	EROSION & SEDIMENT CONTROL PLAN PHASE-1A
C-108	SITE PLAN STA. 48+00-56+00 PHASE-1A	C-502	EROSION & SEDIMENT CONTROL PLAN STA. 0+00-16+00
C-109	SITE PLAN STA. 56+00-64+00 PHASE-1A	C-503	EROSION & SEDIMENT CONTROL PLAN STA. 16+00-32+00
C-110	SITE PLAN STA. 64+00-72+00 PHASE-1A	C-504	EROSION & SEDIMENT CONTROL PLAN STA. 32+00-48+00
C-111	SITE PLAN STA. 72+00-80+00 PHASE-1A	C-505	EROSION & SEDIMENT CONTROL PLAN STA. 48+00-64+00
C-112	CULVERT REPLACEMENT ENLARGEMENT	C-506	EROSION & SEDIMENT CONTROL PLAN STA. 64+00-80+00
C-113	RAILROAD BRIDGE RESURFACING ENLARGEMENT	C-507	CULVERT REPLACEMENT E&S PLAN
S1.1	BRIDGE DEMAND PLAN AND REPAIR NOTES	C-508	EROSION & SEDIMENT CONTROL PLAN DETAILS
S1.2	BRIDGE MODIFICATIONS	C-509	EROSION & SEDIMENT CONTROL PLAN DETAILS
S2.1	HELICAL PILE SUPPORTED BOARDWALK SECTION AND ELEVATION	C-600	CRITICAL AREA BUFFER MANAGEMENT PLAN
S2.2	FRAMING PLANS		

GENERAL NOTES

- ALL WORK SHALL BE IN ACCORDANCE WITH THE LATEST CHARLES COUNTY DEPARTMENT OF PLANNING AND GROWTH
MANAGEMENT SPECIFICATIONS MANUAL, THE LATEST CHARLES COUNTY DETAIL MANUAL AND IN ACCORDANCE WITH
ALL OTHER APPLICABLE COUNTY AND STATE ORDINANCES.
- CONTRACTOR IS RESPONSIBLE FOR CONTACTING "MISS UTILITY" AT 1-800-257-7777, 48 HOURS PRIOR TO ANY
EXCAVATION WORK TO LOCATE ALL UTILITIES IN THE WORK AREA. ANY CONFLICTS MUST BE BROUGHT TO THE
ATTENTION OF THE ENGINEER IMMEDIATELY.
- THE DEVELOPER IS RESPONSIBLE TO HOLD A "PRECONSTRUCTION" MEETING TO INCLUDE THE CONTRACTOR,
CHARLES COUNTY INSPECTION PERSONNEL, PUBLIC UTILITIES, AND ANY LOCAL, STATE OR FEDERAL AGENCIES AS
REQUIRED PRIOR TO THE START OF CONSTRUCTION.
- THE CONTRACTOR IS RESPONSIBLE FOR CONTACTING THE CHARLES COUNTY DEPARTMENT OF DEPARTMENT OF
RECREATION, PARKS AND TOURISM 48 HOURS PRIOR TO THE START OF ALL CONSTRUCTION IN ACCORDANCE TO ALL
PERMITS ISSUED @ (301) 945-0700.
- MAXIMUM SLOPES SHALL BE NOT GREATER THAN THREE (3) FEET HORIZONTAL TO ONE (1) FOOT VERTICAL OUTSIDE
THE ROAD RIGHT-OF-WAY. SLOPES WITHIN THE ROAD RIGHT-OF-WAY SHALL BE NOT GREATER THAN TWO (2) FEET
HORIZONTAL TO ONE (1) FOOT VERTICAL, OR AS SPECIFIED IN THE COUNTY ROAD ORDINANCE AND IN THE CHARLES
COUNTY DETAIL MANUAL.
- CERTIFIED COMPACTION TESTS ARE REQUIRED FOR ALL TRENCH/FILL WORK IN ACCORDANCE WITH THE LATEST
EDITION OF THE COUNTY SPECIFICATIONS MANUAL AND GRADING ORDINANCE. FINAL REPORTS AND CERTIFICATIONS
SHALL BE PROVIDED PRIOR TO PRE-FINAL INSPECTIONS.
- CERTIFIED COMPACTION TESTS AND GEOTECHNICAL REPORTS SHALL BE SUBMITTED ON A BIWEEKLY BASIS
THROUGHOUT THE COURSE OF CONSTRUCTION AS REQUIRED BY THE SPECIFICATIONS MANUAL.
- AS-BUILT PLANS SHALL BE SUBMITTED PRIOR TO FINAL INSPECTIONS FOR ALL DISCIPLINES.
- WITH APPROVAL FROM THE CHARLES COUNTY SEDIMENT CONTROL INSPECTOR, ALL EROSION AND SEDIMENT
CONTROL STRUCTURES MUST BE REMOVED PRIOR TO RECEIPT OF FINAL APPROVAL AND RELEASE OF BONDS.
- PRIOR TO BOND RELEASE ALL OUTCUTS SHALL BE INSPECTED AND APPROVED BY COUNTY.
- TOPOGRAPHY SHOWN IS A BLEND OF LIDAR PROVIDED BY CHARLES COUNTY AND SURVEY CONDUCTED BY VISTA
DESIGN, INC. AT ONE (1) FOOT CONTOUR INTERVALS AS PROVIDED BY VISTA DESIGN, INC. THE VERTICAL DATUM IS
BASED ON THE NAVD 88 DATUM. THE HORIZONTAL DATUM IS BASED ON THE NAD 83 DATUM. TRAVERSE BENCHMARKS
CAN BE FOUND ON THE SITE PLAN.
- THE CONTRACTOR SHALL NOTIFY THE CHARLES COUNTY SEDIMENT CONTROL INSPECTIONS DIVISION AT 301-645-0700,
FIVE (5) DAYS PRIOR TO THE START OF WORK, AND UPON COMPLETION WHEN SEDIMENT CONTROL IS READY TO BE
REMOVED AND TO INCLUDE ALL OTHER REQUIRED SEDIMENT CONTROL INSPECTIONS.
- ALL STREET SIGNS AND REGULATORY SIGNS WILL BE IN PLACE BEFORE PLACEMENT OF ANY ASPHALT. REFER TO THE
MANUAL ON UNIFORM TRAFFIC CONTROL DEVICES FOR PROVIDING SIGNAGE AND REGULATION REQUIREMENTS.
- ALL STORM DRAINS MUST HAVE A MINIMUM 12" VERTICAL COVER BETWEEN ALL OTHER UTILITIES.
- CONTRACTOR SHALL BE RESPONSIBLE FOR FIELD LOCATING AND VERIFYING ALL SERVICE LATERALS PRIOR TO THE
START OF CONSTRUCTION IN PROPOSED DISTURBANCE AREAS. THIS INCLUDES THE PRIVATE PROPANE AND SEWER
SERVICE TO THE EXISTING RESTAURANT AND HOUSE SOUTH OF PROJECT LOCATION.
- CONTRACTOR TO IMMEDIATELY NOTIFY CHARLES COUNTY DEPARTMENT OF RECREATION, PARKS AND TOURISM AND
DESIGN ENGINEER IF FIELD CONDITIONS DIFFER FROM THOSE SHOWN ON PLANS. DESIGN ENGINEER WILL REVIEW
CURRENT CONDITIONS AND ADVISE DEPARTMENT OF RECREATION, PARKS AND TOURISM/CONTRACTOR ON HOW TO
PROCEED.
- THE DEVELOPER OR CONTRACTOR SHALL BE RESPONSIBLE FOR SUBMITTING TO THE CHARLES COUNTY
DEPARTMENT OF PLANNING AND GROWTH MANAGEMENT A LETTER OF MATERIAL CERTIFICATION FROM THE
SUPPLIERS FOR ALL PRECAST STRUCTURES RELATED TO STORM DRAIN SYSTEMS AND STORMWATER MANAGEMENT
FACILITIES IN THE FOLLOWING FORMAT:
17.1. CONTRACTOR'S NAME AND ADDRESS
17.2. PROJECT NAME AND STRUCTURE NUMBER
17.3. MANUFACTURER'S PRODUCT CERTIFICATION
17.4. TYPE AND QUALITY OF PRODUCT
17.5. SHOP DRAWINGS SEALED AND SIGNED BY A PROFESSIONAL ENGINEER REGISTERED IN THE STATE OF MARYLAND.
THE DEVELOPER OR HIS AGENT WILL NOTIFY THE DEPARTMENT FOR FINAL INSPECTION AFTER THE COMPLETION OF
PERMITTED WORK PER APPROVED PLANS. THE DEPARTMENT WILL REQUIRE THE FOLLOWING FOR THEIR FILES:
18.1. AN "AS-BUILT" REPRODUCIBLE PLAN AND SURVEY BY A PROFESSIONAL LAND SURVEYOR AND/OR PROFESSIONAL
ENGINEER AT THE SAME SCALE AS THE ORIGINAL PLAN AND SHOWING ALL IMPROVEMENTS AND FINAL GRADES.
18.2. CERTIFICATION BY THE CONTRACTOR THAT ALL GRADING, DRAINAGE, EROSION CONTROL MEASURES, AND
PERMANENT FACILITIES AND VEGETATIVE MEASURES HAVE BEEN COMPLETED IN CONFORMANCE WITH THE
APPROVED PLANS AND SPECIFICATIONS.
18.3. A REPORT SUMMARIZING THE INSPECTION REPORTS AND TEST RESULTS AS PER SECTIONS 10.2 AND 10.4 OF THE
CHARLES COUNTY STORMWATER ORDINANCE.
19. THE CONTRACTOR SHALL SUBMIT TO THE CHARLES COUNTY DEPARTMENT OF RECREATION, PARKS AND TOURISM
CONCRETE CYLINDER BREAK REPORTS CERTIFIED BY A PROFESSIONAL ENGINEER FOR ALL CAST-IN-PLACE
STRUCTURES USED FOR STORM DRAIN SYSTEMS AND/OR STORMWATER MANAGEMENT FACILITIES.
20. ALL SEDIMENT CONTROL DEVICES SHALL BE CONSTRUCTED, MAINTAINED, AND REMOVED IN ACCORDANCE WITH THE
SPECIFICATIONS AND STANDARD DETAILS GIVEN IN M.D.E.'S "2011 MARYLAND STANDARDS AND SPECIFICATIONS FOR
SOIL EROSION AND SEDIMENT CONTROL".
21. ALL SEDIMENT CONTROL MEASURES WILL BE CONSTRUCTED AND PLACED IN OPERATION BEFORE EXCAVATION IS
STARTED. THE CONTRACTOR SHALL ADJUST THE SEDIMENT CONTROL DEVICES AS NECESSARY TO MEET FIELD
CONDITIONS, AND KEEP THEM CLEAN AND IN WORKING ORDER DURING CONSTRUCTION. NO SEDIMENT CONTROL
DEVICE SHALL BE REMOVED UNTIL THE ENTIRE AREA DRAINING TO IT HAS BEEN PERMANENTLY STABILIZED,
INSPECTED AND APPROVED BY CHARLES COUNTY SEDIMENT CONTROL INSPECTOR.
22. THE CONTRACTOR SHALL TAKE WHATEVER MEASURES ARE NECESSARY TO KEEP MUD AND DEBRIS FROM BEING
TRACKED ONTO PUBLIC ROADS OR ENTERING THE POTOMAC RIVER, POPE'S CREEK AND OTHER WATER BODIES THAT
FEED THE CHESAPEAKE BAY.
23. APPROVAL OF CHARLES COUNTY SEDIMENT CONTROL INSPECTIONS DIVISION AT 301-645-0700 SHALL BE REQUESTED
BY THE CONTRACTOR UPON COMPLETION OF THE INSTALLATION OF PERIMETER EROSION AND SEDIMENT CONTROLS,
BUT BEFORE PROCEEDING WITH ANY OTHER EARTH DISTURBANCE OR GRADING.
24. EROSION AND SEDIMENT PRACTICES, AND SITE IN GENERAL, MUST BE INSPECTED WEEKLY AND AFTER EACH
RAINFALL EVENT BY THE CONTRACTOR OR OTHER RESPONSIBLE PERSON, AND ANY NEEDED MAINTENANCE
PERFORMED IMMEDIATELY.
25. SEDIMENT AND EROSION CONTROLS CANNOT BE REMOVED UNTIL THE SITE HAS ADEQUATE STABILIZATION, ONCE
VEGETATION IS ESTABLISHED, THE SITE SHALL HAVE 95% GROUND COVER TO BE CONSIDERED ADEQUATELY
STABILIZED AND THE SEDIMENT CONTROL INSPECTOR HAS APPROVED SUCH REMOVAL.
26. CONTRACTOR SHALL REPLACE ANY PAVEMENT MARKINGS DAMAGED BY CONSTRUCTION ACTIVITY.

CONSULTANTS CERTIFICATION

I HEREBY CERTIFY THAT THIS PLAN HAS BEEN DESIGNED IN ACCORDANCE WITH THE 2011 STANDARDS
AND SPECIFICATIONS FOR SOIL EROSION AND SEDIMENT CONTROL, OR CURRENT REVISIONS
THEREOF, AND DEPARTMENT OF THE ENVIRONMENT STORMWATER MANAGEMENT REGULATIONS.

MD LANDSCAPE ARCHITECT # 3078
NAME STEVE ENGEL
SIGNATURE DATE
FIRM NAME VISTA DESIGN, INC.
STREET ADDRESS 11634 WORCESTER HWY
SHOWELL, MD 21862

PERMIT INFORMATION

PERMIT NAME	NUMBER	DATE APPROVED	DATE EXPIRED
CHARLES SOIL CONSERVATION DISTRICT PLAN	SED 108-17		
MARYLAND DEPARTMENT OF THE ENVIRONMENT LETTER OF AUTHORIZATION	19-NT-0171/201961035	12/13/2019	12/13/2024
GENERAL TIDAL WETLAND LICENSE	19-PR-0673	12/18/2019	12/17/2022
ARMY CORPS PERMIT	NAB-2019-61035-M43	11/20/2019	9/30/2026
MDE NPDES NOI			
FEMA AUTHORIZATION			
CONCEPT STORMWATER MANAGEMENT PLAN	PGM/MCSWM-190010	5/22/2019	
SITE STORMWATER MANAGEMENT PLAN	PGM/SSWM-190054	11/22/2019	
CHARLES COUNTY DEVELOPMENT SERVICES	DSP-200036		

NOTE:
This drawing, specifications, and work produced by Vista Design, Inc. (VDI) for this project are instruments of service for this project only and remain the copyrighted property of VDI. Reuse or reproduction of any of the instruments of service of VDI by the Client or assignees without the written permission of VDI will be at the Clients risk and be a violation of the copyright laws of the United States of America and the respective state within which the work was completed.
NOTE:
This Drawing does not include necessary components for construction safety. All construction must be done in compliance with the occupational safety and health act of 1970 and all rules and regulations thereupon.

POPE'S CREEK RAIL TRAIL

PUBLIC PEDESTRIAN TRAIL

DEPARTMENT OF RECREATION, PARKS AND TOURISM
CHARLES COUNTY, MARYLAND
4TH ELECTION DISTRICT

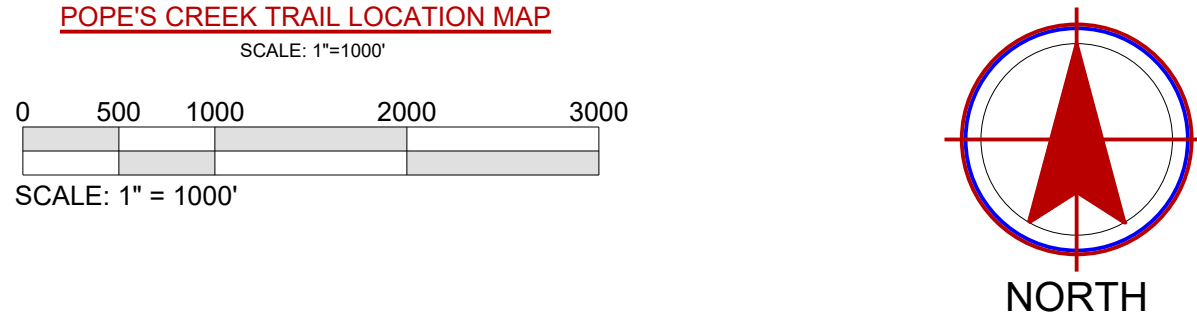
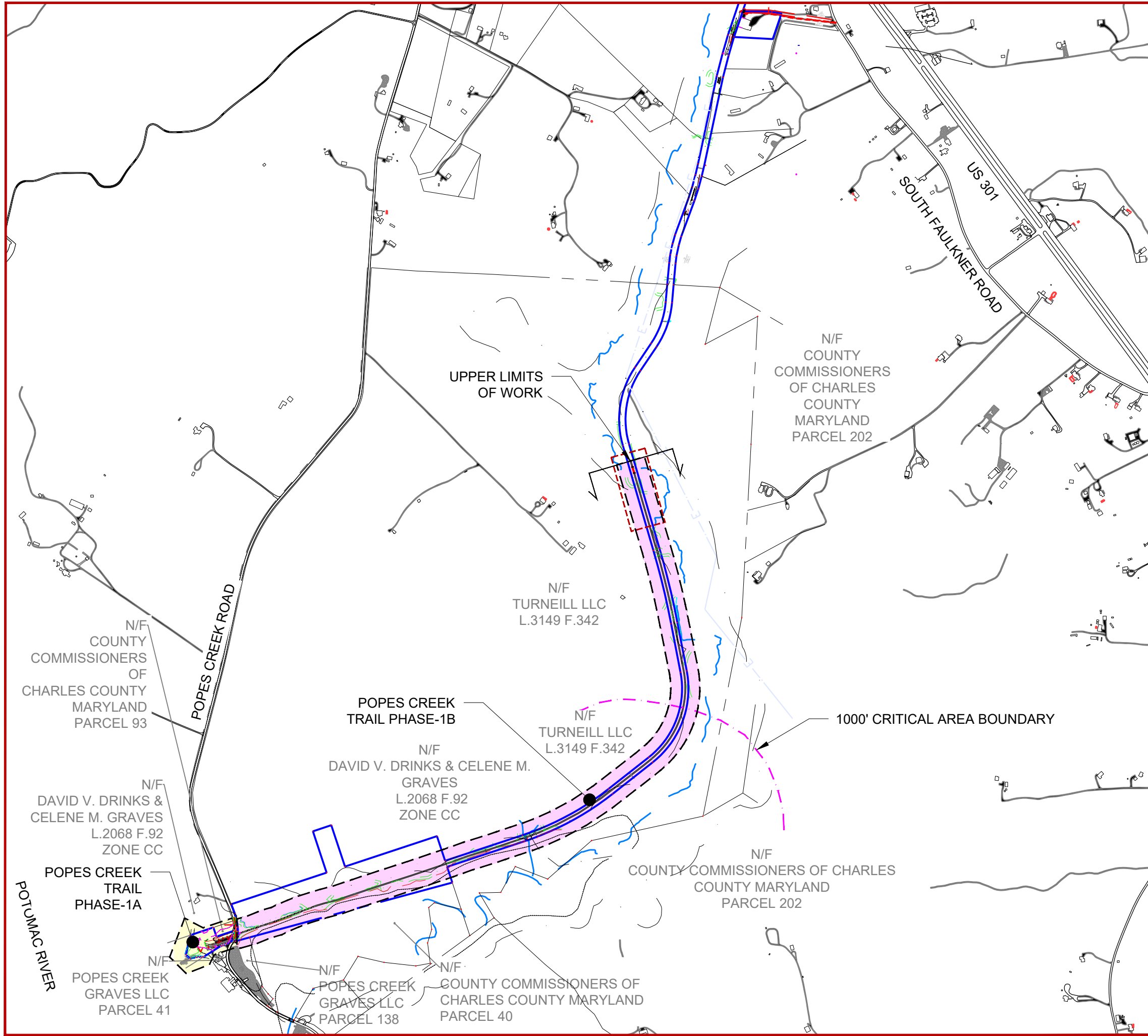

OWNER'S/DEVELOPERS CERTIFICATION (CHARLES COUNTY)

I HEREBY CERTIFY THAT ALL CONSTRUCTION INCLUDING AND NOT LIMITED DRAINAGE, GRADING, STORMWATER MANAGEMENT, ROADS,
AND WATER & SEWER WILL BE DONE PURSUANT TO THIS PLAN, ALL LOCAL, STATE AND FEDERAL CODES AND REQUIREMENTS, CHARLES
COUNTY STANDARDS AND SPECIFICATIONS FOR CONSTRUCTION MANUAL, CHARLES COUNTY DETAILS, APPROVED SITE AND/OR PRELIMINARY
PLANS, OTHER PGM ORDINANCES & REGULATIONS AND ANY OTHER REQUIREMENTS IMPOSED BY CHARLES COUNTY. I HEREBY AUTHORIZE
A RIGHT-OF-ENTRY TO ANY CHARLES COUNTY, LOCAL, STATE OR FEDERAL PERSONNEL FOR THE PURPOSE OF INSPECTION EVALUATION, OR
OBSERVATION OF ANY CONSTRUCTION ACTIVITY RELATED TO THE PROJECT.

OWNER/DEVELOPER SIGNATURE & DATE: *James Sandy* 11-3-21

PRINTED NAME AND TITLE: Tim Drummond Chief of Parks & Grounds

OWNER'S/DEVELOPERS CERTIFICATION (SCD)

I/WE HEREBY CERTIFY THAT ALL CLEARING, GRADING, CONSTRUCTION, VEGETATIVE STABILIZATION AND/OR DEVELOPMENT WILL BE DONE
PURSUANT TO THIS PLAN AND THAT ANY RESPONSIBLE PERSONNEL INVOLVED IN THE CONSTRUCTION PROJECT WILL HAVE A CERTIFICATE OF
ATTENDANCE (4) AT A MARYLAND DEPARTMENT OF THE ENVIRONMENT APPROVED TRAINING PROGRAM FOR THE CONTROL OF EROSION AND
SEDIMENT BEFORE BEGINNING THE PROJECT. I HEREBY AUTHORIZE THE RIGHT TO ENTRY FOR PERIODIC ON-SITE EVALUATION BY STATE OF
MARYLAND, DEPARTMENT OF THE ENVIRONMENT, CHESAPEAKE ARCHITECTS, CHARLES COUNTY INSPECTORS, AND THE REPRESENTATIVES OF THE CHARLES SOIL CONSERVATION
DISTRICT.

SIGNATURE DATE 11-3-21

PRINTED NAME AND TITLE: James Sandy Construction Project Manager, Parks & Grounds

TELEPHONE NUMBER: 301-932-3470

ADDRESS: 8190 Port Tobacco Road Port Tobacco, Md 20677

James Sandy RPO221999

PRINTED NAME AND CARD NUMBER (4) OF ON-SITE RESPONSIBLE PERSONNEL

CONSTRUCTION SET COVER SHEET

REV NO.	CONSTRUCTION REVISION	DATE
1	11/14/23 REVISE PHASING FROM TWO PHASES TO ONE.	

VISTA
DESIGN, INC.
Landscape Architects, Land Planning Consultants, Engineers & Surveyors
11634 Worcester Hwy, Showell, MD 21862
ph. 410-352-3874 fax. 410-352-3875 email vista@vistadesigninc.com

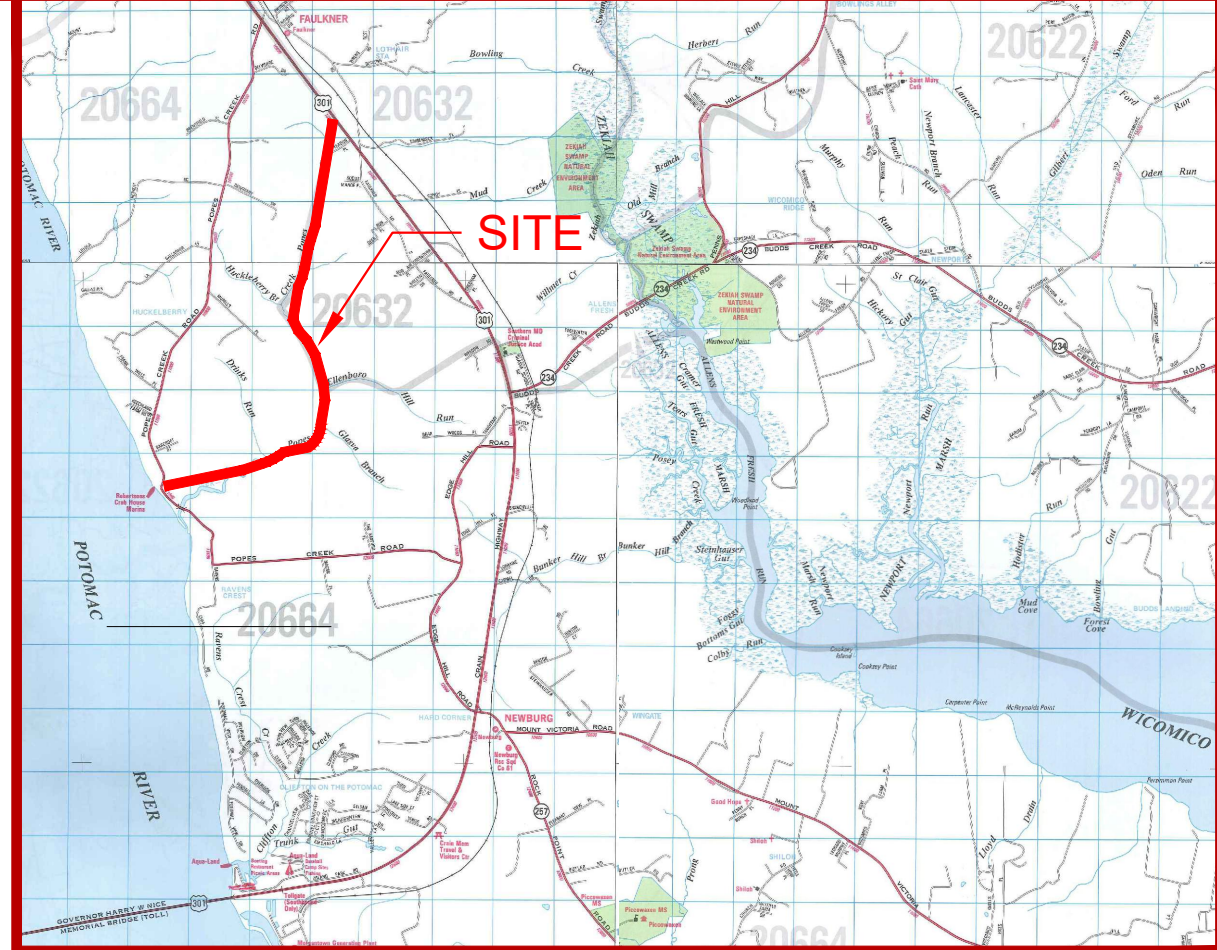

VICINITY MAP
CHARLES COUNTY ADC MAPS 26 & 33
0 6000 12000
SCALE: 1" = 6000'

PROJECT NOTES

- ALL WORK ON THIS PROJECT SHALL CONFORM TO THE LATEST APPROVED SATE HIGHWAY
ADMINISTRATION (SHA) "STANDARD SPECIFICATIONS FOR CONSTRUCTION MATERIALS"
REVISIONS THEREOF OR ADDITIONS THERETO, AS INDICATED IN THE PROJECT DESCRIPTION OF
THE INVITATION FOR BIDS BOOK, THE SPECIAL PROVISIONS INCLUDED IN THE INVITATION FOR
BIDS BOOK, THE ADMINISTRATIONS' BOOK OF STANDARDS FOR HIGHWAY AND INCIDENTAL
STRUCTURES" AND THE LATEST ADOPTED MUTCD.
- THE INTENT OF THIS PROJECT IS TO PROVIDE A HISTORIC PUBLIC ACCESS TO THE POPE'S CREEK
RAIL TRAIL FROM THE POTOMAC RIVER TO SOUTH OF THE JUNCTION WITH US ROUTE 301.
AS DESIGNED, THIS PROJECT WILL BE 1.60 MILES OF 10' NATURAL PATH WITH SECTIONS OF
ELEVATED WALKWAYS AND PEDESTRIAN BRIDGE. THE PROJECT WILL NOT BE ADDING ANY
ADDITIONAL IMPERVIOUS SURFACES TO THE PROPERTIES IT FALLS WITHIN AND PER
CONVERSATIONS WITH CHARLES COUNTY, THE PROJECT WILL BE WAIVED OF ANY WATER
QUALITY TREATMENT DUE TO ITS LINEAR NATURE AND LACK OF IMPERVIOUS SURFACES.
- ALL DESIGN AND CONSTRUCTION OF PEDESTRIAN WALKING PATH AND ELEVATED WALKWAYS
WILL BE DONE UNDER THE CLOSE SUPERVISION OF THE CHARLES COUNTY PARKS AND
RECREATION DEPARTMENT.
- ALL RIGHT-OF-WAY AND PROPERTY LINE INFORMATION PROVIDED TO VISTA DESIGN, INC BY
CHARLES COUNTY DEPARTMENT OF PARKS AND RECREATION VIA DEPARTMENT OF PUBLIC
WORKS, RIGHT OF WAY DEPARTMENT.



PROFESSIONAL CERTIFICATION:

I HEREBY CERTIFY THAT THESE DOCUMENTS WERE
PREPARED OR APPROVED BY ME, AND THAT I AM
A DULY LICENSED PROFESSIONAL ENGINEER UNDER
THE LAWS OF THE STATE OF MARYLAND.
LICENSE NO. 3078, EXPIRATION DATE: 01/18/2027

CHARLES COUNTY GOVERNMENT DEPARTMENT OF PLANNING AND GROWTH MANAGEMENT DEVELOPMENT SERVICES DEPARTMENT

		REMARKS OR CONDITIONS
GRADING	CONSTRUCTION	AS-BUILT
ROADS	CONSTRUCTION	AS-BUILT
STORM DRAINAGE	CONSTRUCTION	AS-BUILT
STORMWATER MANAGEMENT	CONSTRUCTION	AS-BUILT
WATER	CONSTRUCTION	AS-BUILT
SEWER	CONSTRUCTION	AS-BUILT
OTHER	CONSTRUCTION	AS-BUILT
SIGNED:		THIS PERMIT EXPIRES ON:
DATE:		DATE:

CHARLES SOIL CONSERVATION DISTRICT APPROVAL

CHARLES SCD SEDIMENT AND EROSION CONTROL PLAN NUMBER _____

CHARLES SCD SMALL POND APPROVAL NUMBER(S) _____

SEDIMENT AND EROSION CONTROL PLAN AND SMALL POND (IF APPLICABLE) IS HEREBY
APPROVED BY THE CHARLES SOIL CONSERVATION DISTRICT.

THIS APPROVAL EXPIRES
WRITTEN REQUEST FOR EXTENSION MAY BE SUBMITTED TO THE DISTRICT.

THIS PLAN MEETS THE TECHNICAL REQUIREMENTS OF THE U.S.D.A. NATURAL RESOURCES
CONSERVATION SERVICE.

PROJECT DATA

DRAWN BY: BZ
CHECK BY: RP
CHARLES COUNTY
NEWBURG, MARYLAND
F.B. NO. 09004/00163
T.M. NO. M73, G20, P125
DATE: 10/15/25
SCALE: AS SHOWN

15-069

PROJ. NO.

COV 110615

File Name:

G 001

SHEET NO.

PGM# DSP-200036